



Technical data sheet for Dewar flasks cylindrical out of glass type 00 to S 22 C or CAL

Area of application

- ◆ laboratory technique
- ◆ medicinal technique
- ◆ Biotechnology
- ◆ storing and company internal short-distance transport
- ◆ for liquid or solid medias and solid matters (LN₂ oder CO₂)
- ◆ Pressure-less space for coolants

Features of performance

- ◆ reliably and economically
- ◆ Dewar flasks according to DIN EN ISO 16496
- ◆ glass material according to ISO 3585
- ◆ nominal capacity from 100ml to 8 litres
- ◆ protective casing out of blue-coated metal or aluminium



Dewar flask 9 C

Description of complete flasks

Types and accessories

- ◆ C = blue-coated protective casing out of metal
- ◆ CAL = protective casing out of stucco aluminium

Temperature ranges

- ◆ glass refill from -200°C to + 150°C,
for a short time 200°C
- ◆ casing with mounting rubber and Latizell buffer
from -10°C to + 60°C

Pressure range

- ◆ pressure - less

Description of glass Dewar flask

Material

- ◆ borosilicate glass 3.3 ISO 3585

Chemical characteristics

- ◆ hydrolytic resistance: according to ISO 719 (98°C)
- ◆ hydrolytic resistance: according to ISO 720 (121°C)
- ◆ acid resistance: according to ISO 1776
- ◆ alkaline resistance: according to ISO 695-A2

Physical characteristics

- ◆ linear expansion coefficient: $3,3 \times 10^{-6}$ 1/K
(in between 20-300°C)
- ◆ density: 2,23 g/cm³
- ◆ specific thermal capacity: 910 J/kg K
- ◆ transformation temperature: 525°C

Vacuum

- ◆ $> 5 \times 10^{-6}$ mbar

Silvering

- ◆ fully silvered

KGW - ISOTHERM

Karlsruher Glastechnisches Werk
76185 Karlsruhe Gablonzerstraße 6
Tel: 0721 95897-0 Fax: 0721 95897-77
E-Mail: info@KGW-ISOTHERM.COM
Internet: www.KGW-ISOTHERM.COM



Technical data sheet for Dewar flasks cylindrical out of glass type 00 to S 22 C or CAL

Special types

- ◆ Dewar flasks with loosely lied-on plug for gaseous medias
- ◆ Dewar flasks with PE lid and spring clips
- ◆ Dewar flasks with opposite viewing strips in CAL-version only

Safety advises and regulations

- ◆ always wear protective glasses and protective gloves
- ◆ national regulations for laboratories
- ◆ company- internal regulations
- ◆ safety regulations for handling with liquid gases

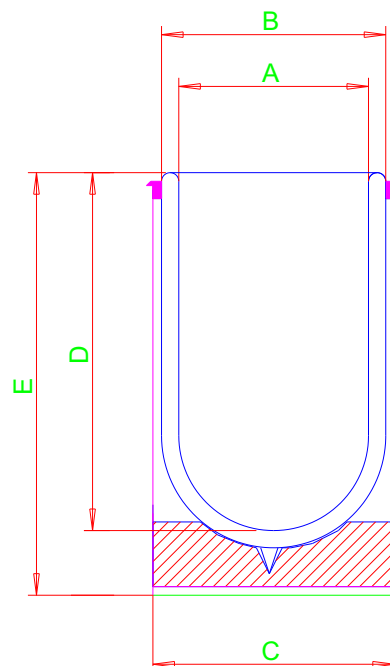

Measurements and order data

Dewar flasks cylindrical, technical specifications

| Type | max.Content ca. [ml] | A mm | B mm | C mm | D mm | E mm | Weight ca. [kg] | Dewar Article No. | Plug Article No. |
|--------|---------------------------|---------|---------|---------|---------|---------|----------------------|----------------------|---------------------|
| 00 C | 100 | 40 | 56 | 63 | 90 | 135 | 0,2 | 1021 | 1721 |
| 0 C | 200 | 40 | 56 | 63 | 170 | 215 | 0,3 | 1022 | 1722 |
| 1 C | 300 | 47 | 60 | 72 | 190 | 240 | 0,3 | 1023 | 1723 |
| 2 C | 450 | 47 | 60 | 72 | 270 | 310 | 0,5 | 1024 | 1724 |
| 3 C | 500 | 57 | 70 | 81 | 210 | 260 | 0,5 | 1025 | 1725 |
| 4 C | 750 | 57 | 70 | 81 | 310 | 370 | 0,8 | 1026 | 1726 |
| 5 C | 1250 | 57 | 70 | 81 | 500 | 550 | 1,3 | 1027 | 1727 |
| 6 C | 800 | 67 | 80 | 90 | 240 | 295 | 0,6 | 1028 | 1728 |
| 7 C | 1200 | 67 | 80 | 90 | 350 | 395 | 0,8 | 1029 | 1729 |
| 8 C | 1700 | 67 | 80 | 90 | 500 | 560 | 1,1 | 10210 | 17210 |
| 9 C | 1000 | 77 | 95 | 105 | 235 | 290 | 0,7 | 10211 | 17211 |
| 10 C | 1500 | 77 | 95 | 105 | 345 | 395 | 1,1 | 10212 | 17212 |
| 11 C | 2100 | 77 | 95 | 105 | 500 | 550 | 1,8 | 10213 | 17213 |
| 12 C | 1500 | 90 | 115 | 124 | 245 | 300 | 1,1 | 10214 | 17214 |
| 13 C | 2000 | 90 | 115 | 124 | 340 | 390 | 1,4 | 10215 | 17215 |
| 14 C | 3200 | 90 | 115 | 124 | 600 | 665 | 2,5 | 10216 | 17216 |
| 15 C | 1500 | 100 | 120 | 130 | 240 | 300 | 1,2 | 10217 | 17217 |
| 16 C | 2000 | 100 | 120 | 130 | 290 | 345 | 1,4 | 10218 | 17218 |
| 17 C | 4000 | 100 | 120 | 130 | 600 | 660 | 2,9 | 10219 | 17219 |
| 18 C | 2500 | 110 | 130 | 140 | 290 | 345 | 1,7 | 10220 | 17220 |
| 19 C | 5000 | 110 | 130 | 140 | 600 | 660 | 3,2 | 10221 | 17221 |
| 20 C | 3000 | 138 | 160 | 165 | 230 | 280 | 1,4 | 10222 | 17222 |
| S 21 C | 4000 | 138 | 160 | 165 | 310 | 375 | 2,4 | 10223 | 17223 |
| S 22 C | 8000 | 138 | 160 | 165 | 600 | 660 | 4,6 | 10224 | 17224 |

KGW - ISOTHERM

Karlsruher Glastechnisches Werk
76185 Karlsruhe Gablonzerstraße 6
Tel: 0721 95897-0 Fax: 0721 95897-77
E-Mail: info@KGW-ISOTHERM.COM
Internet: www.KGW-ISOTHERM.COM

Dewargefäße Type 00 - S22 E 05/2018
Seite 2 von 2