



Technical data sheet for Dewar carrying flasks type 26-29 B or B-E

Area of application

- laboratory technique
- medicinal technique
- Biotechnology
- storing and company internal short-distance transport
- for liquid or solid medias and solid matters
- pressure-less space for coolants

Features of performance

- reliably and economically
- Dewar flasks according to DIN EN ISO 16496
- glass material according to ISO 3585
- nominal capacity from 1 to 4 litres
- protective casing out of blue-coated metal

Description of complete flasks

Types and accessories

- B = blue-coated protective casing out of metal
- B-E = protective casing out of stainless steel
- carrying handle = pure aluminium
- lid = polyethylene, white
- clamps = stainless steel, electrolytic polished

Temperature ranges

- glass refill from - 200°C to + 150°C, for a short time +200°C
- lid to + 80°C
- casing with mounting rubber and Latizell buffer to + 60°C

Pressure range

- pressure - less



Dewar flask 26 B



Dewar flask 26 B-E

Description of glass Dewar flask

Material

- borosilicate glass 3.3 ISO 3585

Chemical characteristics

- hydrolytic resistance: according to ISO 719 (98°C)
- hydrolytic resistance: according to ISO 720 (121°C)
- acid resistance: according to ISO 1776
- alkaline resistance: according to ISO 695-A2

Physical characteristics

- linear expansion coefficient: $3,3 \times 10^{-6} 1/K$ (in between 20-300°C)
- density: $2,23 \text{ g/cm}^3$
- specific thermal capacity: 910 J/kg K
- transformation temperature: 525°C

Vacuum

- $> 5 \times 10^{-6} \text{ mbar}$

Silvering

- fully silvered

KGW - ISOTHERM

Karlsruher Glastechnisches Werk
76185 Karlsruhe Gablonzerstraße 6
Tel: 0721 95897-0 Fax: 0721 95897-77
E-Mail: info@KGW-ISOTHERM.COM
Internet: www.KGW-ISOTHERM.COM



Technical data sheet for Dewar carrying flasks type 26-29 B or B-E

Special types

- small insulation flasks with bore hole in the lid for gaseous medias
- small insulation flasks with PTFE lid
- small insulation flasks with silicone sealed lid

Safety advises and regulations

- always wear protective glasses and protective gloves
- national regulations for laboratories
- company- internal regulations
- safety regulations for handling with liquid gases
- ADR regulations

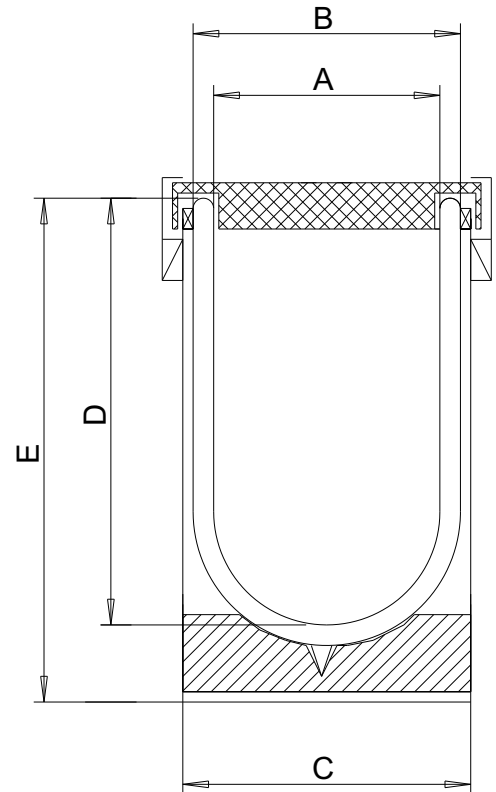

Measurements and order data

Technische Angaben / Technical Specifications / Caractéristiques techniques

Typ	max. Inhalt	A	B	C	D	E	Gewicht	Standzeit LN2	Verdampfungsrate LN2
Type	max. Content						Weight	Holding time LN2	Evaporation rate LN2
Types	Capacité max.						poids	Durabilité LN2	Taux d'évaporation LN2
	ca. [L]	mm	mm	mm	mm	mm	ca. [kg]	ca. [h]	ca. [L / d]
26 B (26BE)	1	100	120	132	150	215	1,5	17	1,2
27 B (27BE)	2	138	160	170	170	245	2,3	23	1,9
28 B (28BE)	3	138	160	170	230	305	2,8	40	1,6
29 B (28BE)	4	138	160	170	310	385	3,3	71	1,4

Artikel-Nummern / Article numbers / Référence

Typ	Artikel Nr.	Typ	Artikel Nr.	Ersatzglas	Artikel Nr.
Type	Article No.	Type	Article No.	Glass Refill	Article No.
Types	Référence	Types	Référence	Récipient replacement	Référence
26 B	1211	26 BE	1221	26 A	1201
27 B	1212	27 BE	1222	27 A	1202
28 B	1213	28 BE	1223	28 A	1203
29 B	1214	29 BE	1224	29 A	1204

KGW - ISOTHERM

Karlsruher Glastechnisches Werk
 76185 Karlsruhe Gablonzerstraße 6
 Tel: 0721 95897-0 Fax: 0721 95897-77
 E-Mail: info@KGW-ISOTHERM.COM
 Internet: www.KGW-ISOTHERM.COM